

Wireless Door Entry Alarm & Counting System (Infrared Beam)/Solar Panel Included.

Applications

- Garage Door/Door Way/Overhead Door/Swing Gate/Entrance /Super Market/Restaurant/Warehouse /Dental/Book Store---etc.

Features

- Wireless Retro-Reflective Photoelectric Beam Sensor
- Range: 3.14 to 22 feet (0.5~ 7 meters)
- 4 Digits Counter (DC-500) -- **Optional**
- Solar Panel Included.
- 3.7V Lithium-Ion rechargeable battery pack (1,230 mAH)
- Switching Power Supply Mode AC/DC Adaptor
- Wireless Photo Beams to Speaker
- Volume of Speaker: Adjustable
- Sounding Time: 3~30 seconds
- Door Chime/Alarm Speaker Included.

Specifications

Photoelectric Beam Sensor	
Type	Infrared Receiver Modules for Remote Control Systems
Housing	ABS
Radio Frequency	433.92 MHz (315, 866 MHz available also.)
LED Emitting Element	Infrared LED Indicator (Red)
Sensing Range	3.14 to 22 feet (0.5~ 7 meters)
Power Supply	A · 3.7V Lithium-Ion rechargeable battery pack (1,230 mAH) B · solar panel
Current Drain (mA)	Standby (Beam Aligned properly): 3.7 mA/Beam Broken:14 mA
Duration of Battery	If the sensor trigger less than 2,000 times per day, then The battery can be lasting 10 days (also the solar panel is working not proper.)
Power input wire	DC Jack (φ)5.5mm/2.1mm x (L)12cm

Wireless Door Announcer	
Type	Microprocessor based control unit
Housing	ABS
Radio Frequency	433.92MHz
Coverage Range	≥100m (Open space)
Volume of Speaker	0 ~ Max (Adjustable)
Chime/Alarm Time	30 sec max. (Adjustable)
Power Supply (Input)	AC/DC Adaptor (100-240VAC/50-60Hz → 12VDC/0.5A)
Power input Jack	DC Jack (φ)5.5mm/2.1mm
Power Supply (Output)	12VDC/130 mA
Power output Jack	Phone Jack (φ)3.5mm
Temperature	0°C ~ 50°C

Solar panel	
Type	0.8W Solar panel
Housing	ABS
Power output wire	DC Plug (φ)5.5mm/2.1mm x (L)5m , Black

4 Digits Counter (Optional)	
Type	4 Digits Counter (Number can be adjusted +/-/Reset)
Housing	ABS
Power Supply	12VDC/130mA (same power source as speaker)
Power input wire	Phone Plug (φ)3.5mm

Wiring Connection:

Please make sure that the solar panel will be shined by sunlight 6~8 hrs at least every day.
Also please install the efficient & proper of solar panel V.S. sunlight.

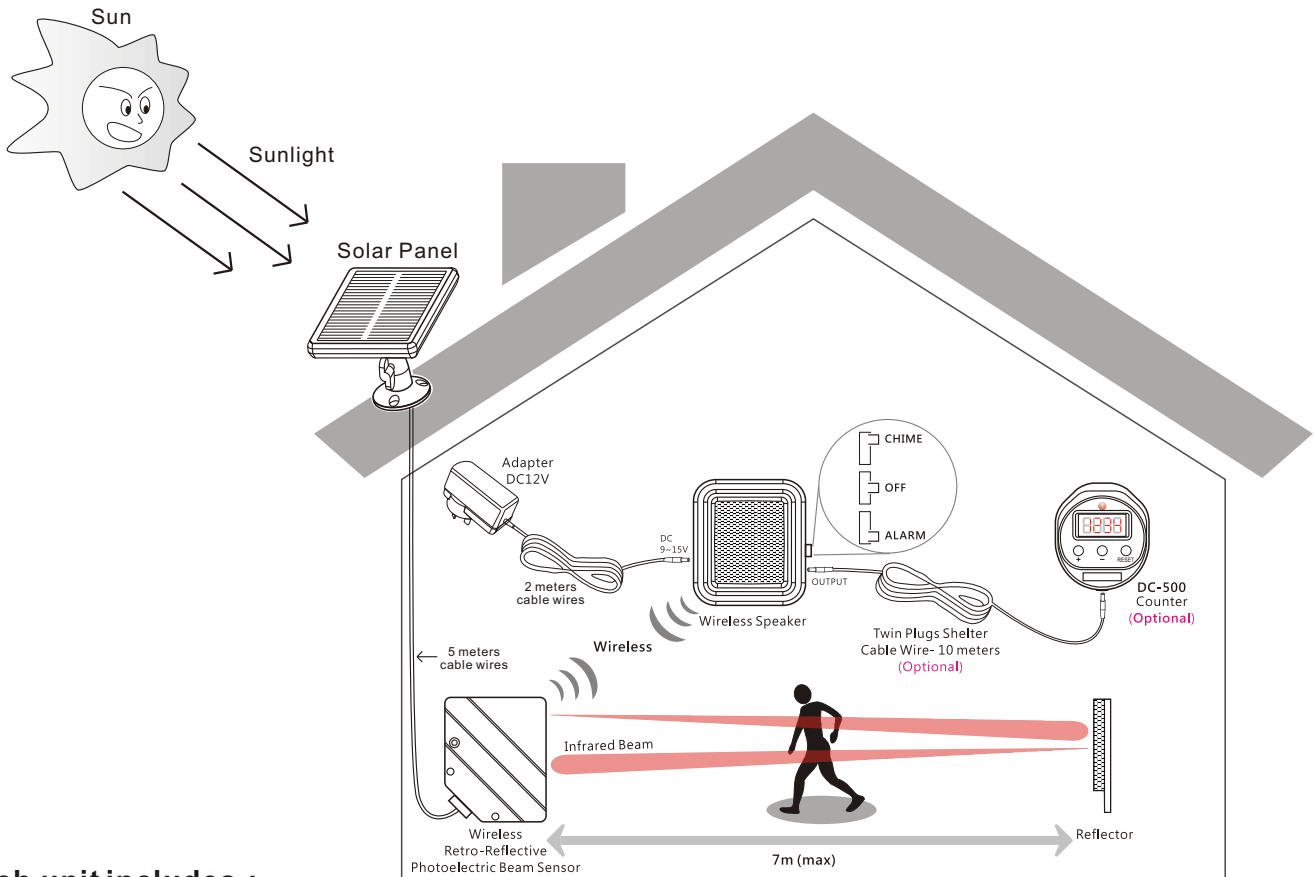

Each unit includes.:

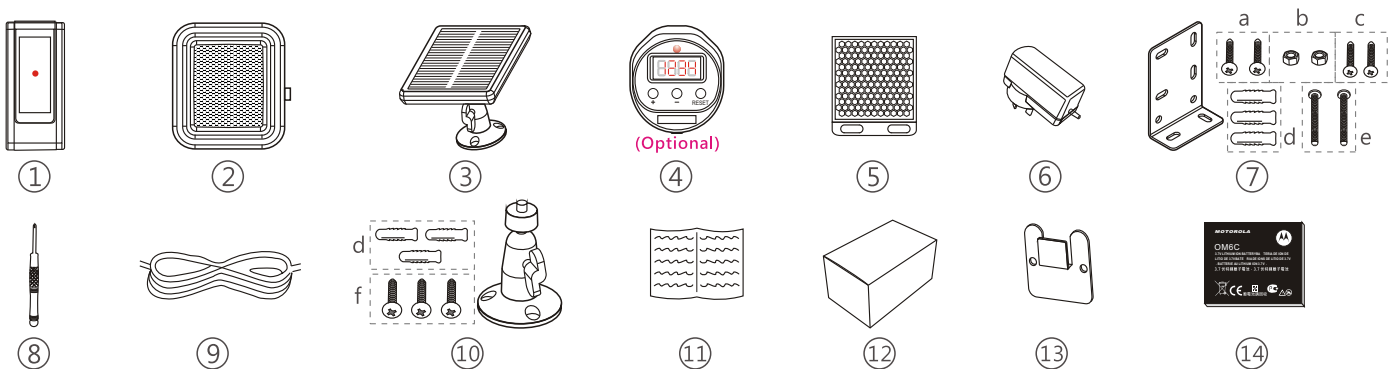

- 1 · Wireless Retro-Reflective Photoelectric Beam Sensor (Model No.: DES-700WL-Photocell)
- 2 · Wireless Speaker (Chime/Alarm Sound selectable) (Duration and volume of Chime/Alarm adjustable) (Model No.: SPK-300)
- 3 · Solar Panel (Model No.: SP-300) **Remark: Optional**
- 4 · 4 Digits Counter (optional) (Model No.: DC-500)
- 5 · Reflector (Model No.: SR-50G)
- 6 · AC/DC Adaptor (Switching Mode) (Model No.: SPS-300)
- 7 · Mounting Bracket & screws for Sensor (Model No.: MB-300)
- 8 · Screw driver for Duration and volume adjustment of speaker (Model No.: SD-300)
- 9 · 5 meters cable wires (from Solar Panel to Sensor) (Model No.: CBSS-5)
2 meters cable wires (from Adaptor to Speaker) (Model No.: AS-2) **Remark: Optional**
10 meters cable wires (from Speaker to 4 Digits Counter) (Model No.: SD-10)
- 10 · Mounting Bracket & Screws of Solar Panel (Model No.: MB-200)
- 11 · Manual
- 12 · Inner box (color or white box)
- 13 · MB-100: Mounting Bracket for DC-500 (4 digits counter)
- 14 · 3.7V Lithium-Ion rechargeable battery pack (1,230 mA)

a : 4×19	2 pcs
b : NUTS	2 pcs
c : 3×19	1 pcs
d : Wall plug	6 pcs
e : 4×45 NI	2 pcs
f : 4×26	3 pcs

Standard Installation (Battery Pack)

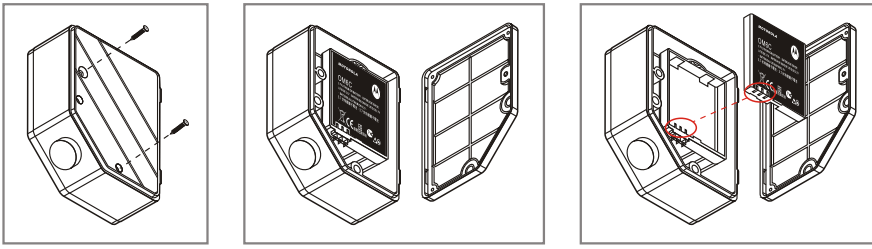

Introduction to accessories & dimensions:

A · DES-700WL-Photoelectric Beam Sensor & Bracket (MB-300)

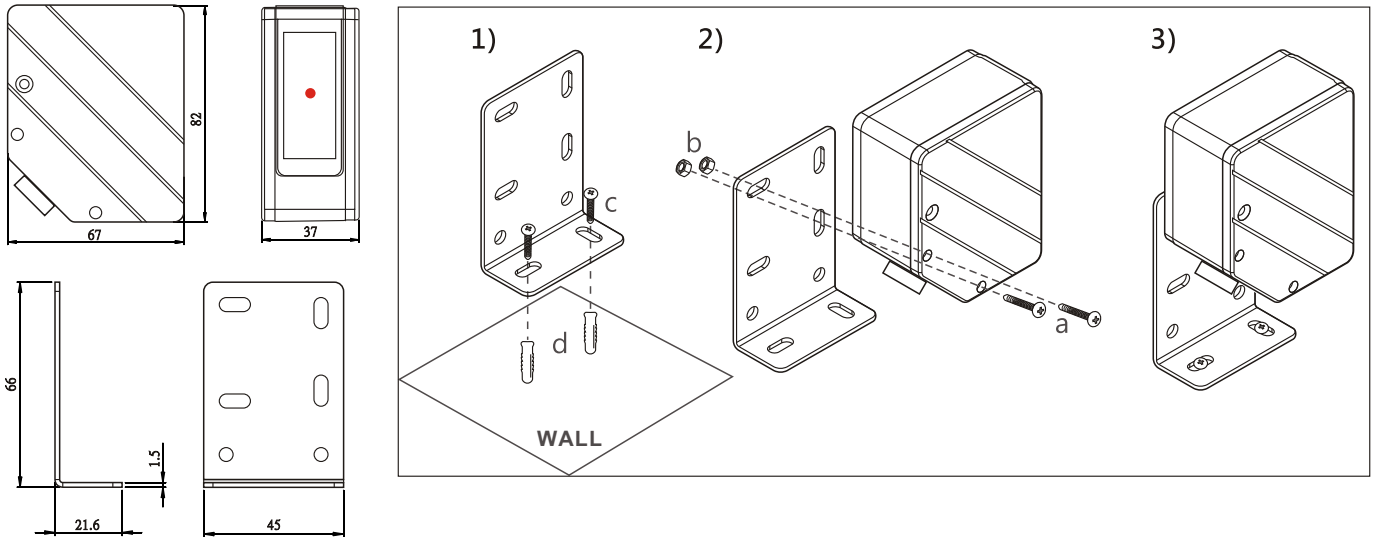

B · SPK-300: Siren

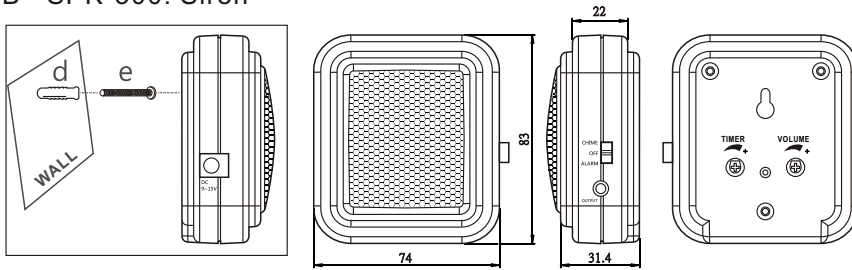

C · DC-500: 4 Digits Counter & Bracket

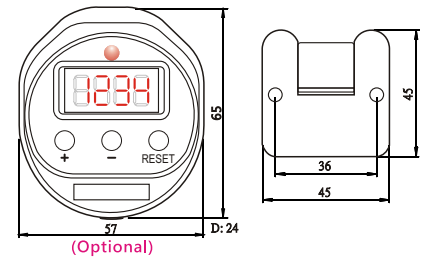

D · SP-300: Solar Panel & Mounting Bracket (MB-200)

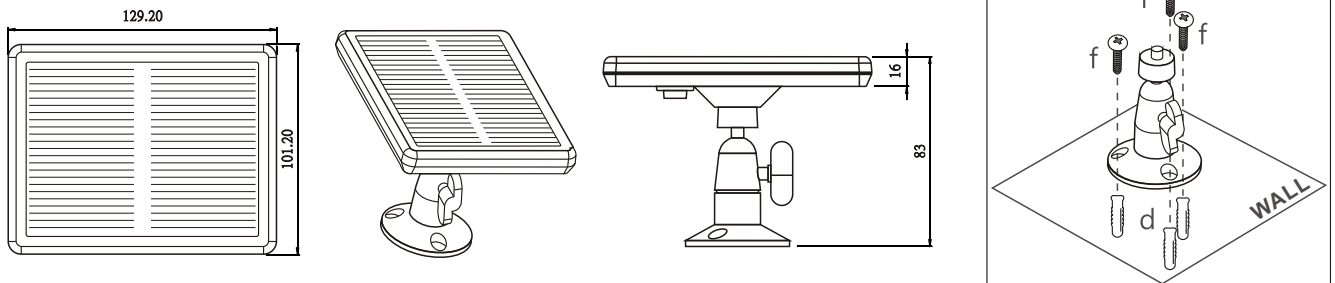

Standard Installation (DC-500)

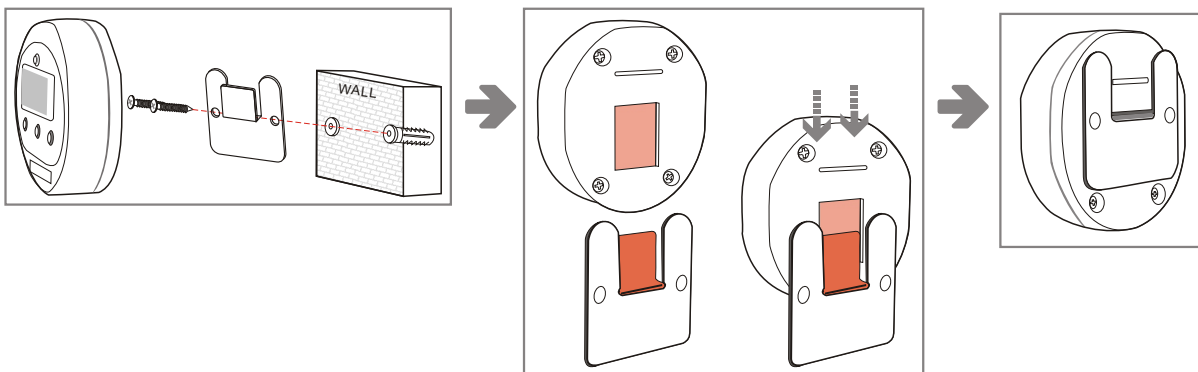

1. Please check that the speaker is switched to the "Chime" or "Alarm" position. (Off=Silent)

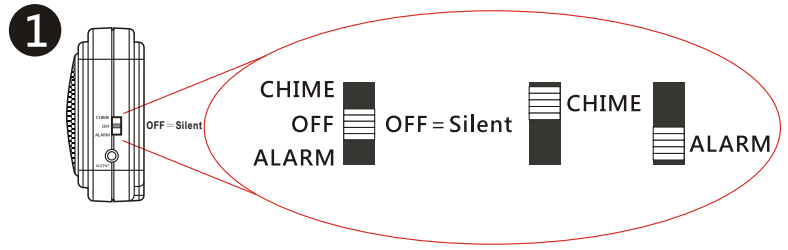

2. Please check that the timer and volume potentiometers are NOT in their min. Position.

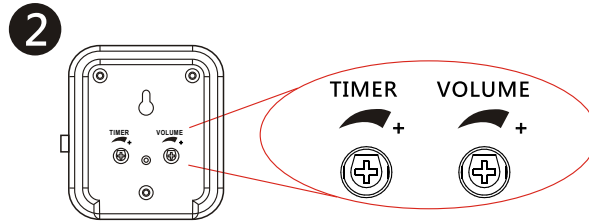

3. The red LED will illuminate when the beam is properly aligned, if the LED is not on please realign the beam.

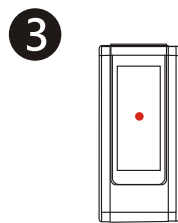

4. The reflector should be mounted a minimum of 50 cm from the sensor otherwise it will be impossible to align the beam properly.

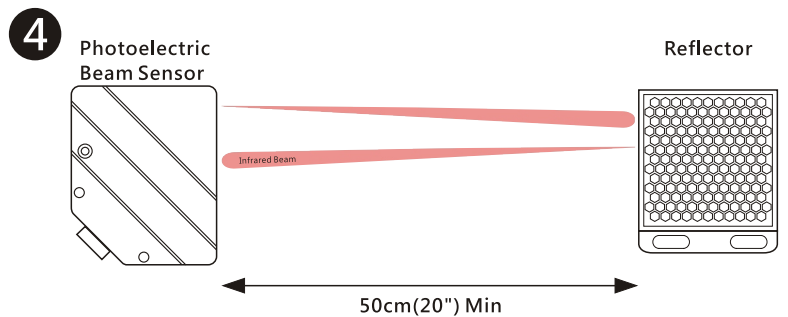

5. Make sure the plug of AC/DC adaptor is inserted into the DC9~15V socket of the speaker.

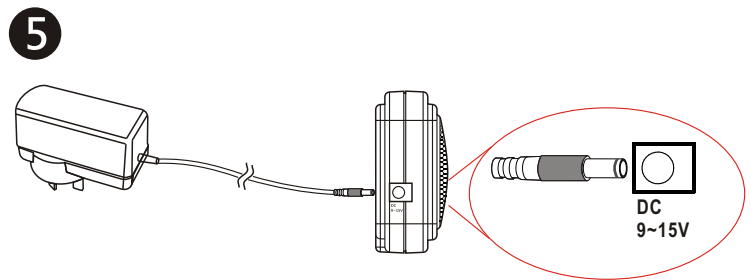

6. If you have purchased the 4 digits counter (optional), it should be connected to the "OUTPUT" of the speaker via the included 10 m cable.

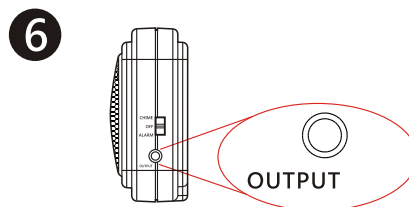

7. Please use the attached screwdriver in the inner box, Don't use any other size.

